

Frequently Asked Questions.

- Is the shed open to men of all ages?
Yes, men of all ages are welcome. This encourages the exchange of skills and ideas.
- What does it cost to join?
Currently, 2018—2019, membership is \$50 a year.
- Is there a subscription?
Yes, \$2 per visit to the shed.
- What if you don't live in Mundaring?
Men are welcome from any area.
- What if I have no practical skills?
There is always a wealth of knowledge and skills available at the shed to help you.



Mundaring Community Men's Shed (Inc)
Patron:- Prof. Ron Dullard

3205 Jacoby St
Mundaring WA 6073

Tel (08) 9295 6813
Email mundaringshed@gmail.com



Visiting Dowerin for The Field Day

Opening Times

Monday to Friday
9.00 am to 3.00 pm and the last
Saturday of the month 9.00am to 12 pm.

Sundowner at 2.00pm on the second Thursday
of the month.

General Meetings 2.00pm on the third Thursday
of the month at;
The Hub of the Hills,
Craig Street, Mundaring.

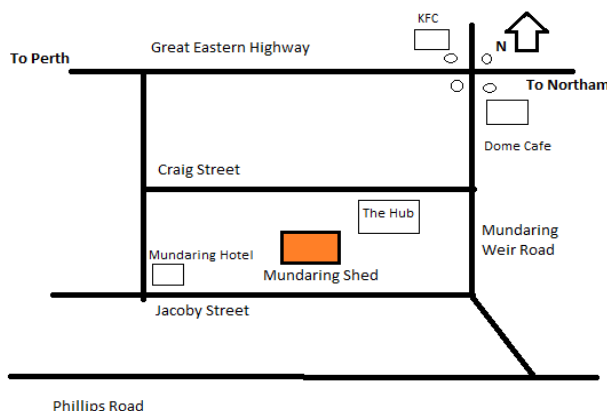

MCMS acknowledges the support of:
The Shire of Mundaring, Bendigo Bank Mundaring,
Lottery West, Rotary Club & Lions Club Glen
Forrest.

For more information contact:
Barry on 0407 607 172 or
Ross on 0433 211 949 or
Phone the shed during opening hours.

Fifth edition February 2019

MUNDARING COMMUNITY MEN'S SHED (INC)

ESTABLISHED 2007



Blokes Building Better Communities

3205 Jacoby Street,
Mundaring, WA 6073

Wheelchair accessible.

Mundaring Community Men's Shed

Established in 2007, the Mundaring Men's Shed (Inc) held its early meetings in the Hub of the Hills Community Centre in Mundaring.



The Shire of Mundaring agrees to lease the old fire shed to MCMS November 2008



The Lottery West cheque arrives in September 2009

In March 2010 the shed building was officially opened by Frank Alban MLA having been fitted out with machinery and equipment financed by a Lottery West grant.

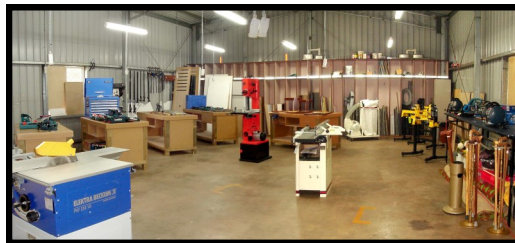

The New Woodwork Shed in 2010



The "New building" opened in 2015

Our Aims

The Mundaring Community Men's Shed, a not-for-profit organization, aims to provide a friendly environment in which men can ;

- Get together,*
- Serve the local community,*
- Be creative,*
- Expand their social network,*
- Support and help each other,*
- Promote inter-generational, family and cultural interaction.*

What can you do at the shed?

There are numerous things to do at the shed. You can;

- Bring your own projects
- Work on projects for local community groups or individuals
- Meet and just have a chat and a cuppa
- Contribute to "Shed" projects
- Volunteer to help with local community events
- Visit places of interest
- Enjoy a social event
- Discuss personal wellbeing.

What activities are available?

- Woodworking
- Wood Turning
- Wood Carving
- Model making
- Metalwork
- Welding
- Computing
- Games

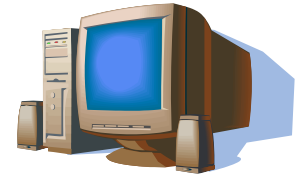

Examples of

